

RAY-BAR FIRE RATED HOLLOW METAL WINDOW FRAME PROFILES

IT IS THE RESPONSIBILITY OF THE CUSTOMER TO VERIFY AND CONFIRM FIRE RATING REQUIREMENTS PRIOR TO ORDERING

EQUAL RABBET PROFILE

AVAILABLE IN THESE
FIRE RATINGS IN MINUTES
20 • 45 • 60 • 90

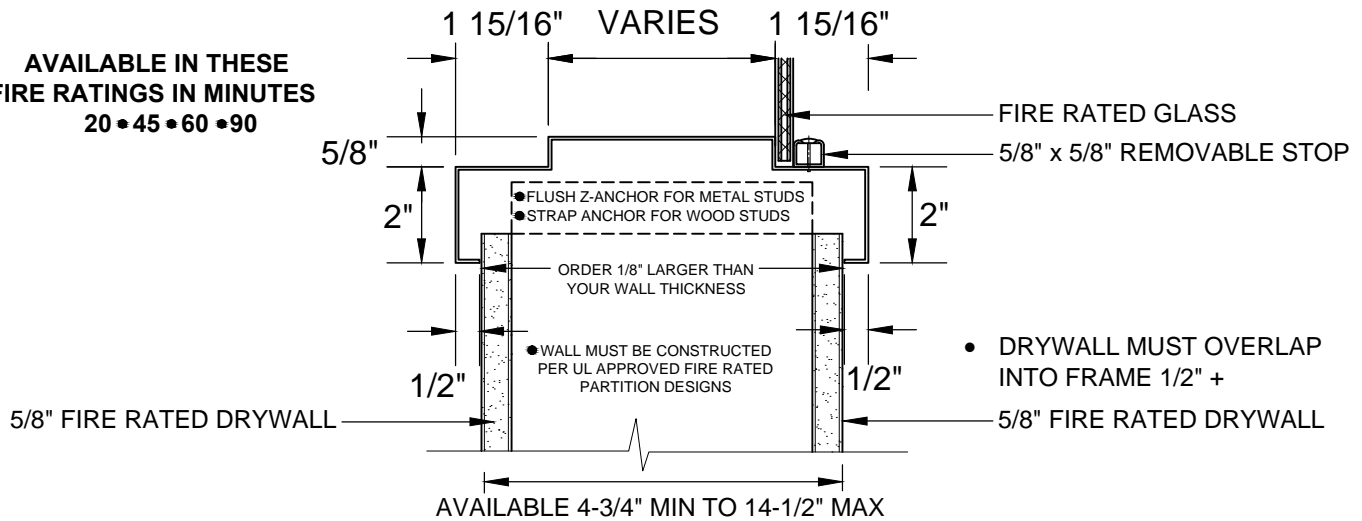

SINGLE RABBET PROFILE

AVAILABLE IN THESE
FIRE RATINGS IN MINUTES
20 • 45 • 60 • 90

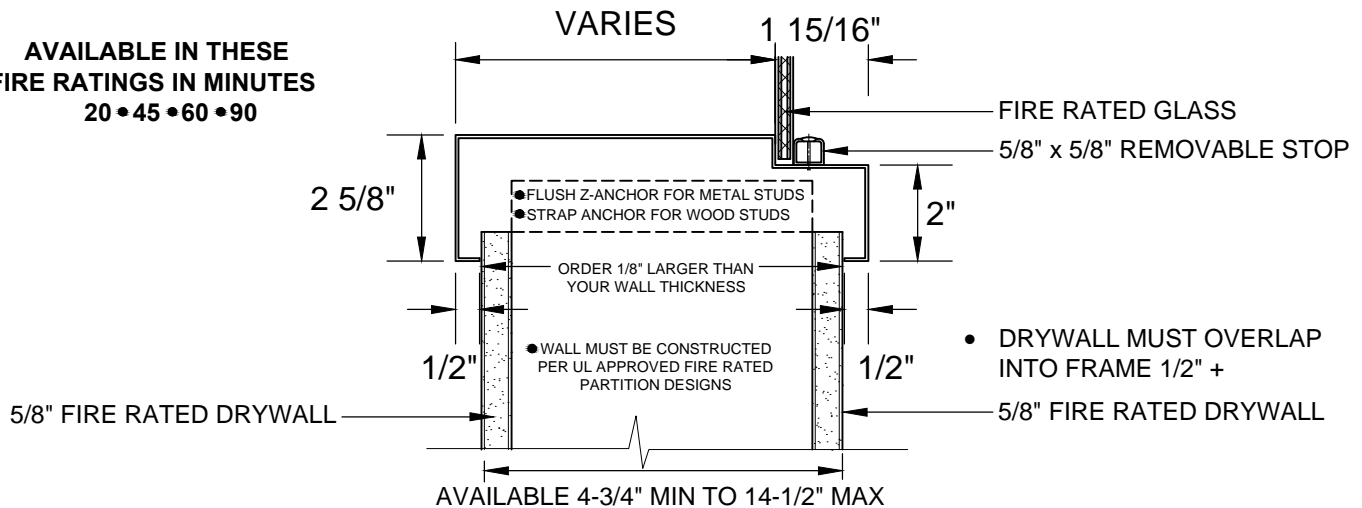

FIRE RATED WINDOW FRAMES: GLASS OPTION

- CLEAR VIEW SIZE LIMITS APPLY DEPENDING UPON FIRE RATINGS
- AVAILABLE WITH 3/16" FIRELITE GLASS

IMPACT RESISTANT MEETING ANSI Z97.1 AND CPSC 16 CFR 1201 CAT 2 SAFETY GLASS:

- 3/16" FIRELITE-NT (FILMED)
- 5/16" FIRELITE-PLUS (LAMINATED)
- 1/4" WIRELITE-NT (FILMED)

OTHER FIRE RATED GLAZING OPTIONS:

- PYROSTOP (LAMINATED / INTUMESCENT)
- FIRE RATED INSULATED GLASS UNITS (IGU)

OTHER PERFORMANCE OPTIONS (IGU):

- LOW-E
- RADIATION PROTECTION
- INSULATED
- SECURITY



Terms of Use: Certain designs and concepts are the exclusive proprietary property and work product of Ray-Bar Engineering provided in good faith as a courtesy for the architectural design of projects specifying, incorporating and utilizing genuine Ray-Bar products and assemblies. Ray-Bar designs are not to be copied, altered, plagiarized or utilized in any competitive or detrimental manner against Ray-Bar as protected by law and/or copyrights. "All Rights Reserved"



JOB NAME:
LOCATION:
ROOM NUMBER:
SHEET ____ OF ____:

RAY-BAR FIRE RATED WINDOW FRAME PROFILES

RAY-BAR ENGINEERING CORP.

Toll Free: 1(800) 444-XRAY / 1(800) 444-9729
Telephone: (626) 969-1818
24 Hour Fax: 1(800) 333-XRAY /
1(800) 333-9729

WWW.RAYBAR.COM

RAY-BAR
FIRE RATED
WINDOW
FRAMES
PROFILES

RB-FRWF-P