

RAY-BAR FIRE RATED HOLLOW METAL DOOR FRAME

IT IS THE RESPONSIBILITY OF THE CUSTOMER TO VERIFY AND CONFIRM FIRE RATING REQUIREMENTS PRIOR TO ORDERING

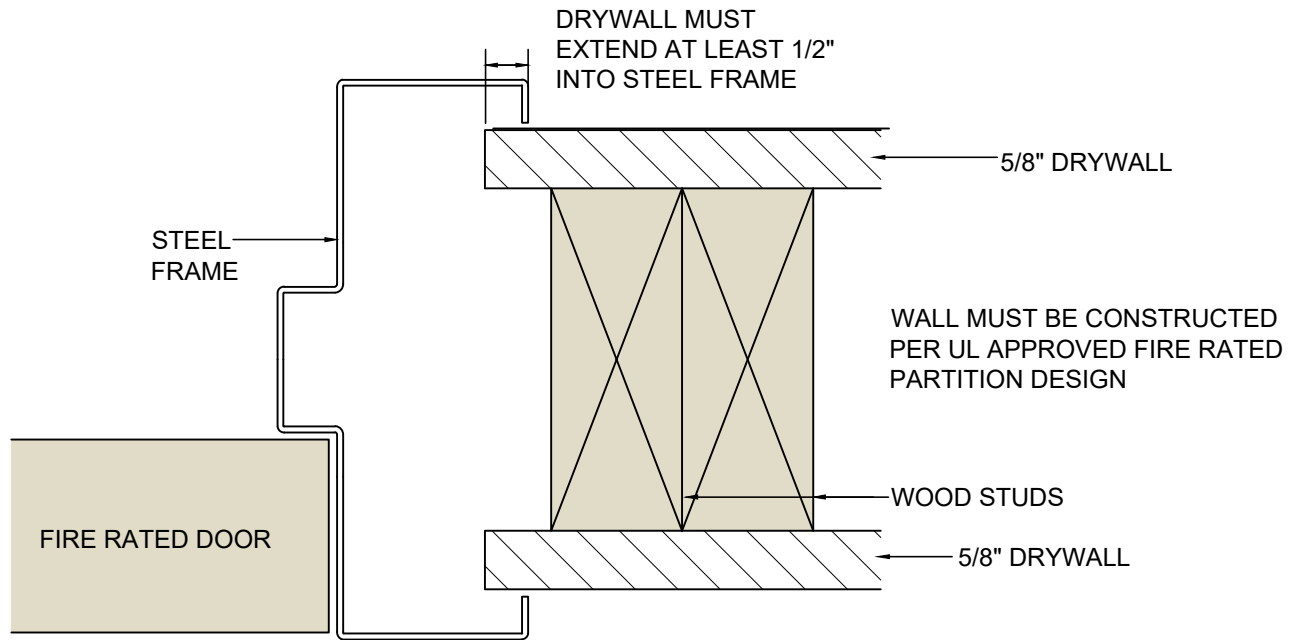

DOORS AVAILABLE WITH FIRE RATED VISION FRAMES

- AVAILABLE WITH FIRELITE-NT, FIRELITE + PLUS, WIRELITE-NT, FIREGLASS 20 OR PYROSTOP
- FIRE RATED INSULATED GLASS UNITS (IGU)
- SIZE LIMITS APPLY DEPENDING ON RATING



Terms of Use: Certain designs and concepts are the exclusive proprietary property and work product of Ray-Bar Engineering provided in good faith as a courtesy for the architectural design of projects specifying, incorporating and utilizing genuine Ray-Bar products and assemblies. Ray-Bar designs are not to be copied, altered, plagiarized or utilized in any competitive or detrimental manner against Ray-Bar as protected by law and/or copyrights. "All Rights Reserved"

| | |
|---------------------------------------|---------------------|
| | JOB NAME: |
| | LOCATION: |
| | ROOM NUMBER: |
| | SHEET ____ OF ____: |
| RAY-BAR FIRE RATED HOLLOW METAL FRAME | |

| | |
|--|---|
| RAY-BAR ENGINEERING CORP. Toll Free: 1(800) 444-XRAY / 1(800) 444-9729 Telephone: (626) 969-1818 24 Hour Fax: 1(800) 333-XRAY / 1(800) 333-9729 website: www.raybar.com www.xrayglass.com | RAY-BAR WOOD STUD FIRE RATED FRAME RB-FRDF |
|--|---|